

IN-LINE FLUID WARMERS



In-line fluid warmers warm diesel fuel so gelling does not occur in cold temperatures.

BENEFITS

- Improves efficiency by providing trouble-free operation in cold climates
- Stainless steel components eliminate corrosion and contamination of the fuel
- Easy to install in the fuel lines

WHERE TO USE

Serve larger diesel fuel customers:

- Locomotives
- Over-the-road trucks
- Oil and mining equipment
- Off-road vehicles



I-909BTEH-B100



I-909BT-B100



I-1518BT-B100



I-1530BT-B100

IN-LINE FLUID WARMERS

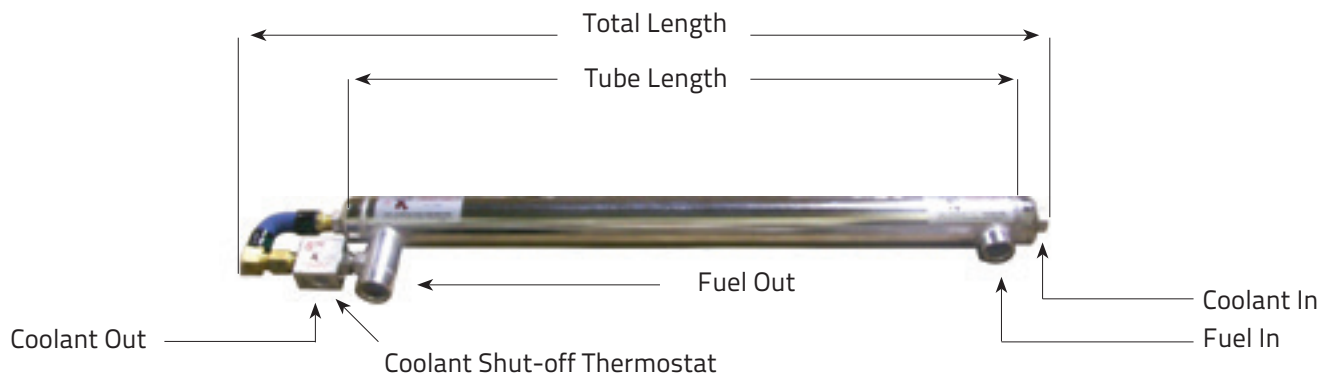

DIMENSIONAL & BRACKET REPLACEMENT PARTS INFORMATION

NOTE: All models made of 304 Stainless Steel—Maximum Coolant Operating Pressure 25 psi (172.4kPa) Pre heat option does NOT include power cord—Contact Arctic Fox for proper cord to match your application

Part No.	Coolant Port	Fuel Port	Tube Length	Tube O.D.	Total Length	Surface Area	Pre Heat Option
I-909BT-B100	1/2" NPT	1/2" NPT	9.75"/248mm	2.0"/51mm	15.5"/394mm	100" ² /645.2cm ²	No
I-909BTEH-B100	1/2" NPT	1/2" NPT	9.75"/248mm	2.0"/51mm	18.5"/470mm	100" ² /645.2cm ²	120 VAC
I-1518BT-B100	1/2" NPT	1" NPT	18.0"/457mm	2.375"/60mm	25.5"/648mm	320" ² /2064.5cm ²	No
I-1530BT-B100	1/2" NPT	1" NPT	30.0"/762mm	2.375"/60mm	37.0"/940mm	532" ² /3432.3cm ²	No

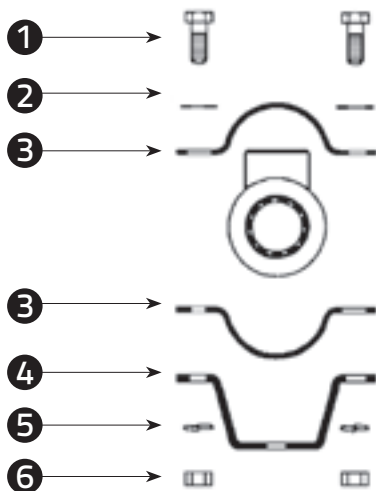

Item	Model	Part #	Description
1	All	A-321	3/8" UNC X 1.0" Long Bolt
2	All	A-311	3/8" SAE Flat Washer
3	I-909 I-1518 / I-1530	A-307 A-1356	Half Moon Bracket
4	I-909 I-1518 / I-1530	A-308 A-1361	U-Bracket
5	All	A-310	3/8" Split Lock Washer
6	All	A-309	3/8" UNC Nut

NOTE: Bracket components listed above are included with each unit in the proper quantity to support the heat exchanger.